

The template above can be helpful when locating holes needed for mounting the RazorGage Table Attachment Bracket. A full size drawing is on the second page of this document. Once you've constructed the template place it on your saw as shown in the diagram below. The 7/16" holes called out are about the right size for a large Sharpie permanent marker. Mark the holes, center punch them, and then drill and tap 5/16-18 holes as necessary. The template is designed so that you can flip it around and drill holes on either the left or right sides of the saw.

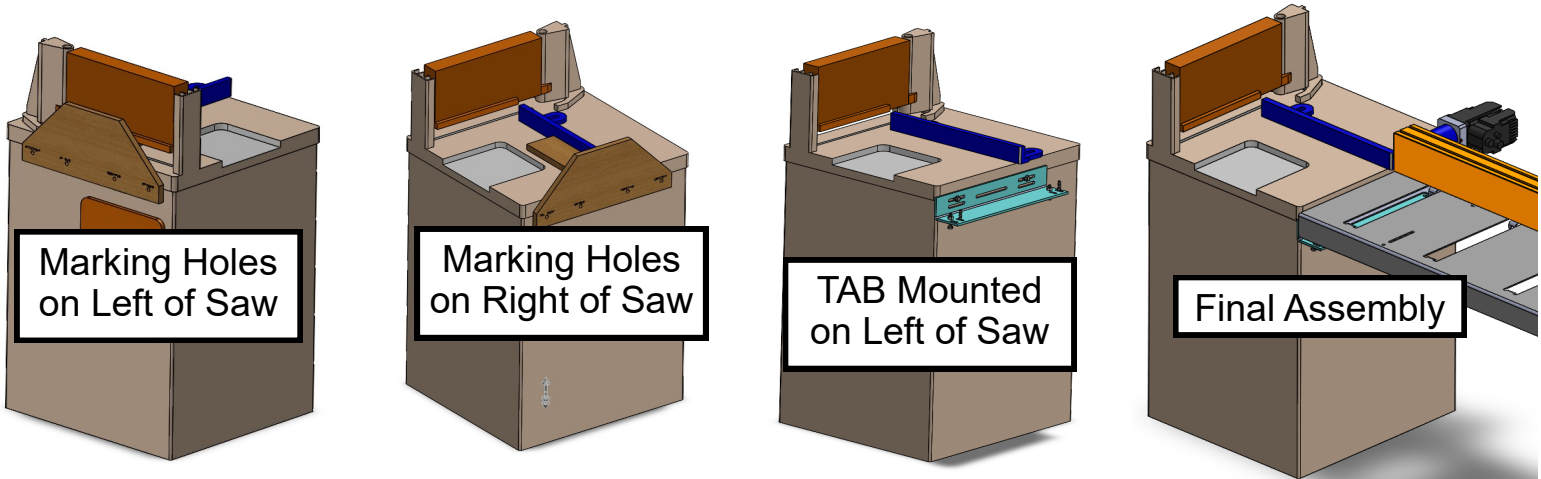

REV	DESCRIPTION	DATE	APPROVED

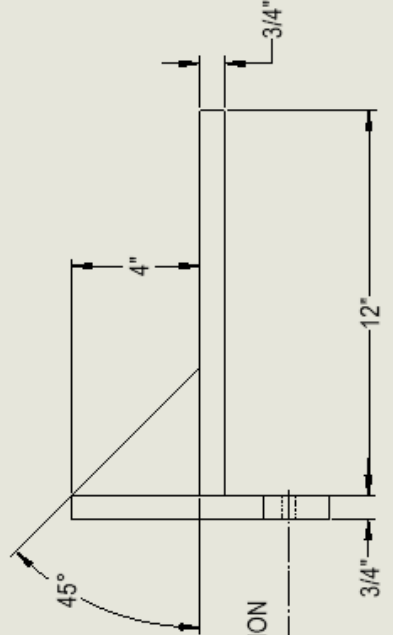
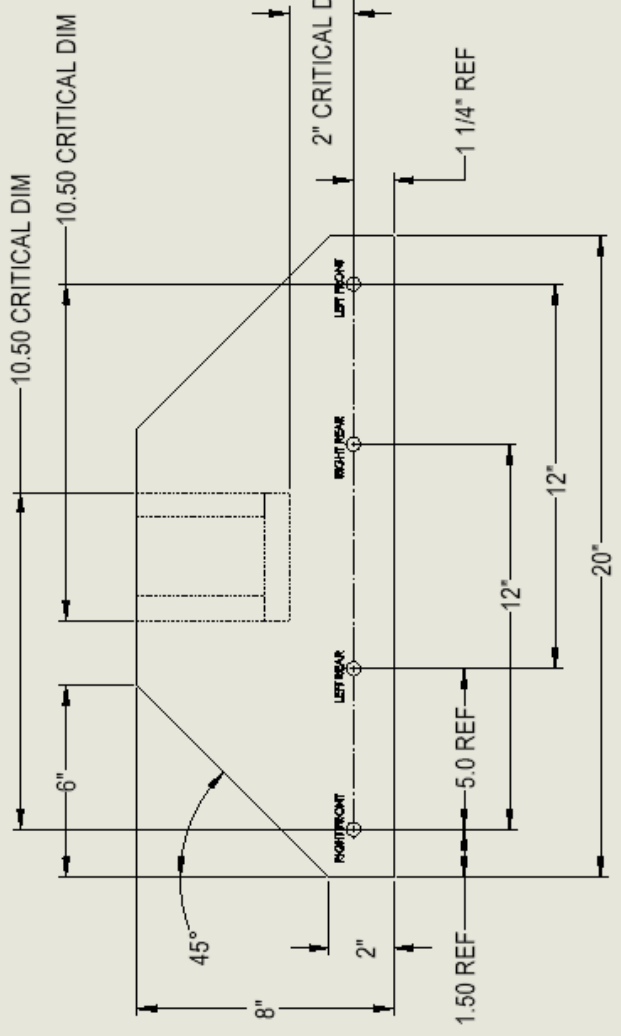
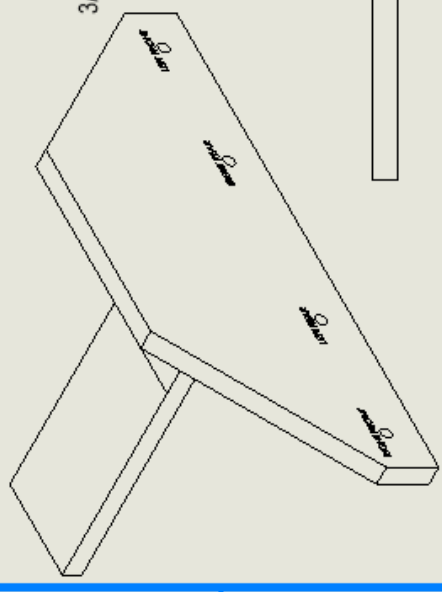
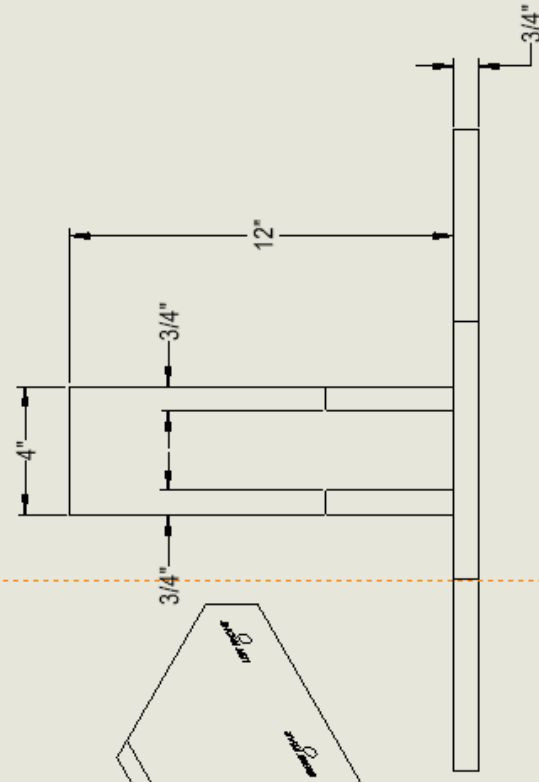
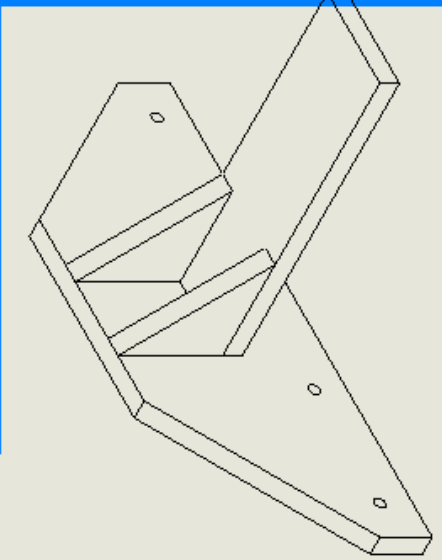

DATE	DESCRIPTION	DATE	APPROVED

STANDARD NOTES:
 TOLERANCE UNLESS OTHERWISE SPECIFIED:
 FRACTIONAL ± 1/16
 DECIMAL ± 0.015
 ANGLES ± 1°
 UNLESS OTHERWISE SPECIFIED ALL SHARP EDGES INTERPRET DRAWING PER ASME Y14.5-1994

DATE: 2/20/2013 10:32:09 AM
 DRAWN BY: [Name]
 JOB NO.: [Number]
 DATE ORDERED: [Date]
 DATE RECEIVED: [Date]

TECHNICAL SERVICES INC.
 CUSTOM AUTOMATION FOR INDUSTRY
 AMES, IA

HOLE MARKING TEMPLATE FOR RATORCAGE TABLE ATTACHMENT BRACKET

REV: [Number]
 B RGD1210-004
 SHEET 1 OF 1

QUANTITY: 1
 MATERIAL/FINISH: 3/4" Plywood