

RAZORGAGE

POSITIONERS • SOFTWARE • SYSTEMS

RazorGage ST Miter Stop Explained

Most positioner manufacturers design their miter stop for use with double miter saws this way. They mount their positioner in the front and then use a stop that is mitered on the end that traps the mitered stock between the stop and the fence. This is a poor design for several reasons:

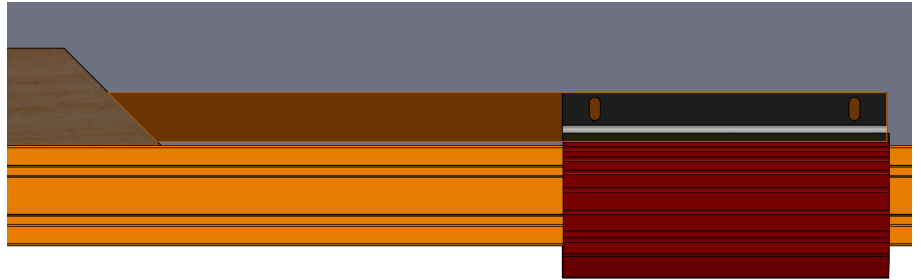

1) The part acts as a wedge which forces the stop away from the fence. The more force the operator applies, the more the deflection which causes variation in the part length.

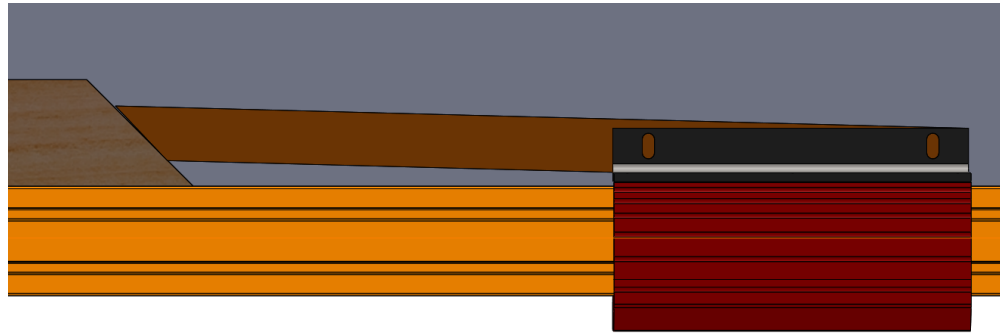

2) The positioner must be mounted in the front in order to align with the fence on the saw thus impedes loading.

3) With the positioner mounted in the front, its drive motor now protrudes toward the operator. If the motor is oriented on the saw end, it is in the operator's way.

If it is oriented on the far end, the system requires longer cables that must be managed as they make their way back to the control enclosure.

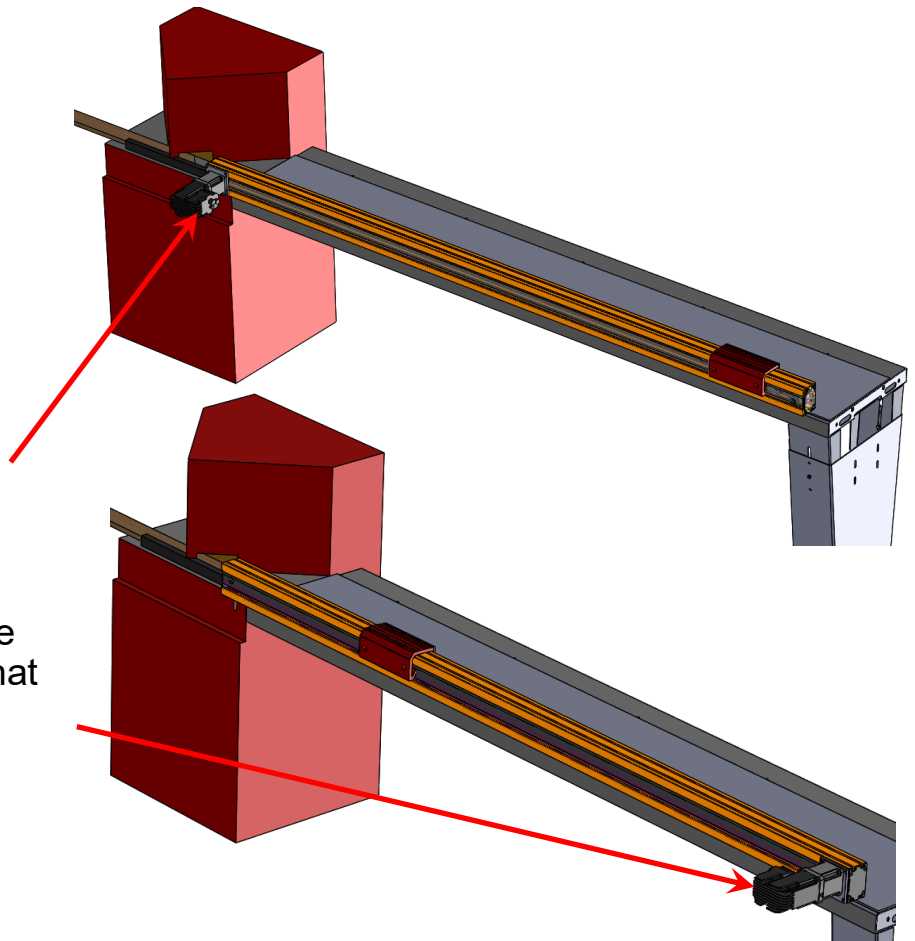

RazorGage uses a bird's mouth design which completely captures the end of the mitered part. Extra force from the operator doesn't wedge the stop apart and thus doesn't result in length variation. This design also allows us to mount the RazorGage in the back making part loading easy and open. The motor points to the rear so it can be near the saw and the control enclosure without being in the operator's way.

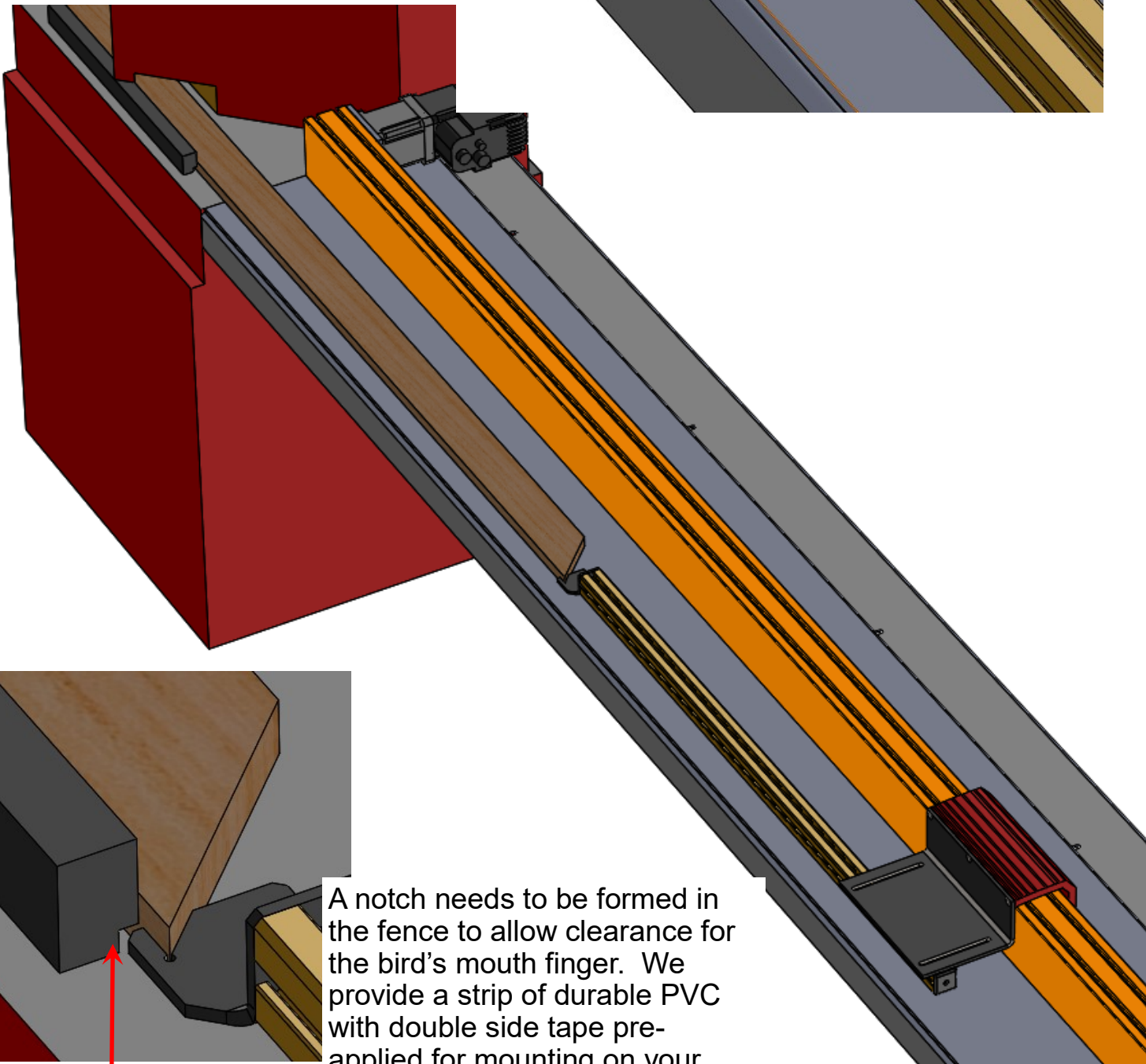
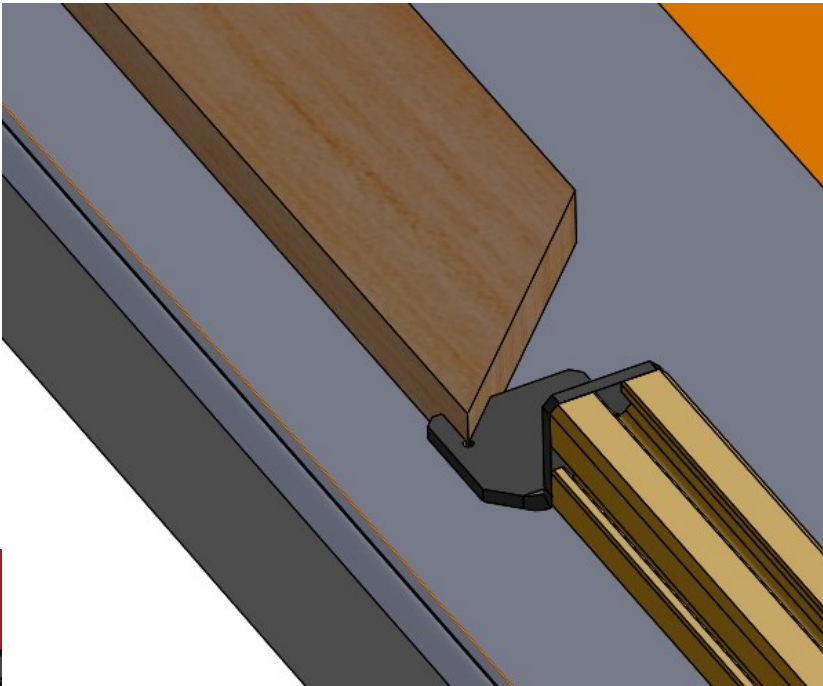

A notch needs to be formed in the fence to allow clearance for the bird's mouth finger. We provide a strip of durable PVC with double side tape pre-applied for mounting on your existing fence to create the

TOP VIEW

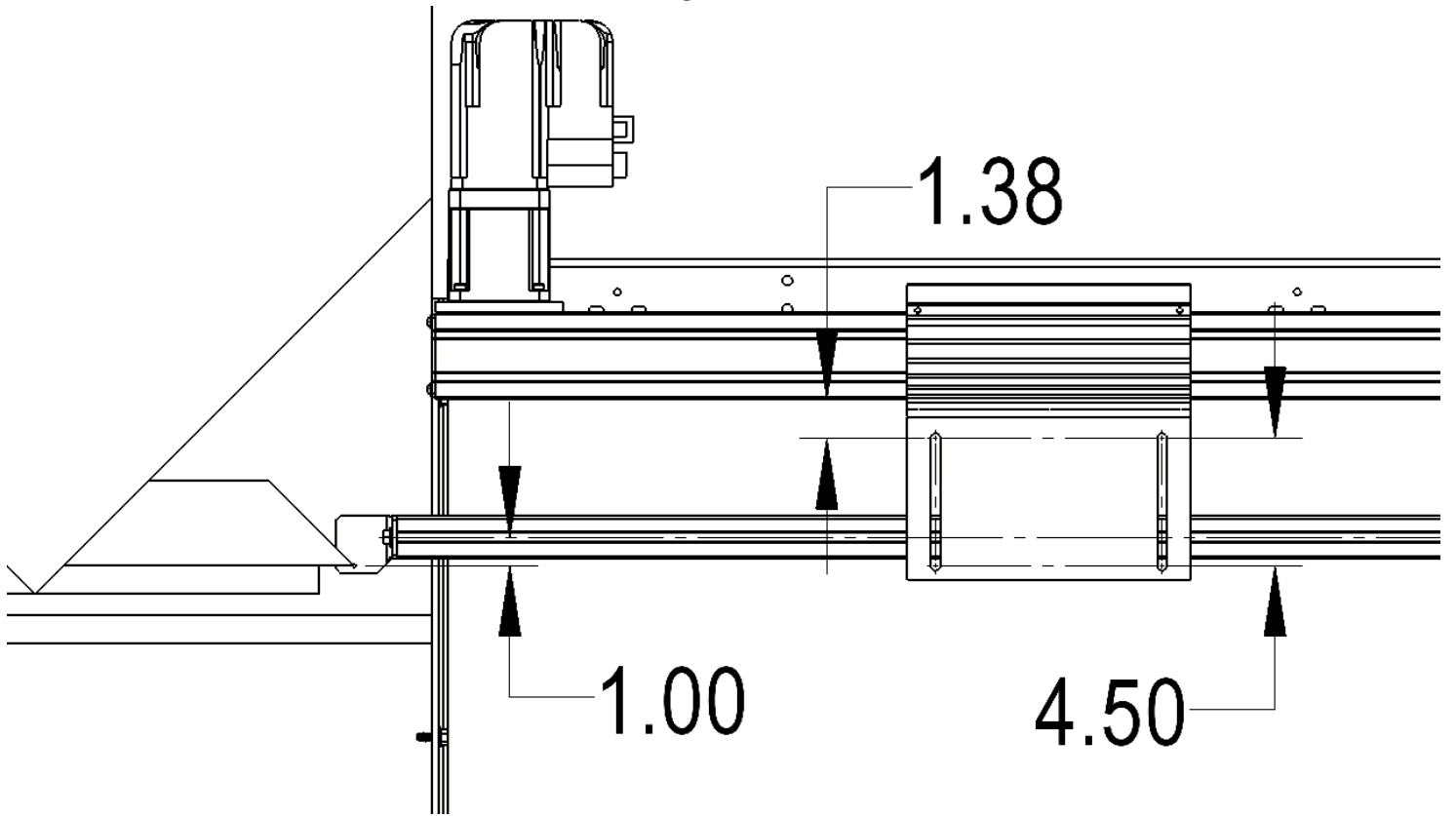

END VIEW

